

Lyon Workspace Product

8000 Series Tee Post Shelving

Duffel Bag Specification Sheet

Open Uprights

All posts are punched on 1 ½” centers with pairs of parallel slots 11/16” long, with one slot keyhole-shaped for bolting cross braces and accessories to uprights. Consist of two 16 gauge, hot rolled, formed steel “T”s 1-1/2” x 2-1/8” x 1/8” with one pair of 1”x 12 gauge band cross braces. Upright size is 32” deep x 87” high.

Shelf Clips

12 gauge, hot rolled, one piece construction. Four clips required per shelf..

Shelves

Extra Heavy Duty (X) Industrial Shelves

Overall shelf size is 48”wide x 32” deep nominal. The actual size will be 47-13/16”w x 32”d.

18-gauge with front and rear “Box W” formation. The front and rear “Box W” formation is not less than 1 11/64” x 27/32” x 1 1/8” with a 9/16” return flange spot-welded to bottom surface of the shelf. The 27/32” portion of the “Box W” formation shall have a 10-degree bend in the center for additional strength and rigidity. The front and rear flanges of the shelf shall be punched to accept bin fronts, label holders, and other accessories. Ends are to be flanged not less than 1 11/64” with a 90 degree return flange of not less than 5/8”. All corners are lapped and welded. All shelves are punched on 3” centers for divider attachment. The front and rear flanges of the shelf are to be embossed with “18 GA”.

Shelves also punched at four corners for bolting to uprights. Advertised shelf load for this shelf size is 750# but contains a minimum safety factor of 1.67

Three 5/16” diameter holes are punched in the front face of the shelf on 14” centers and equally spaced from each end of the shelf. Hole in face has a matching hole in the back of the box formation.

Components

Lateral Cross Brace

1” x 12 gauge band formed and punched at each end to bolt to the upright post.

Cable Components

Cable

Steel wire – Galvanized 7x19 Strand construction 1/8” diameter bare and 3/16” thick clear vinyl coated. Breaking strength 2000 lbs. Supplied in 17” lengths. 3 lengths per each shelf.

Reference MMC # 8912T511 part number.

Lyon Workspace Product 8000 Series Tee Post Shelving Duffel Bag Specification Sheet

Oval Sleeves

Compression oval sleeve for 3/16" diameter cable. 7/8" sleeve length. 2 sleeves required for each wire. Reference part # MMC3896T5

Compression Tool

Lyon is quoting a multidiameter compression tool to crimp the compression sleeves. Reference part # MMC 3582T3

Front View Shelf Punching For Cables

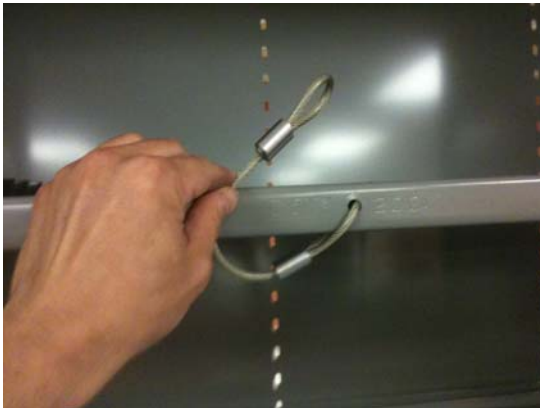
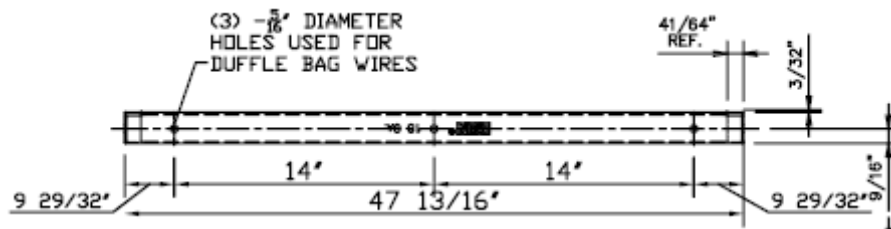

Cable with compression sleeve



Final shelf assembly with 3 cable assemblies

Lyon Workspace Product 8000 Series Tee Post Shelving Duffel Bag Specification Sheet

