

TOOL BAR ASSEMBLY

48" / 60" / 72"

KEY	PART NUMBER	DESCRIPTION	48"	60"	72"
A	A007178	Spread Bar 48"	1		
A	4007284	Spread Bar 60"		1	
A	A007285	Spread Bar 72"			1
	BB79312	Tool Trolley Car	1	1	1
	A007182	MOUNTING BRACKET	2	2	2
	020007	3/8-16 X 1 GRADE 2"	2	2	2
	150007	Plastic Insert Cap	2	2	2

**MISSING PARTS OR IN NEED
OF
ASSEMBLY ASSISTANCE?**

Contact us direct for fast friendly service (800) 433-8488

Int'l calls (630) 892-8941 | WEB: WWW.LYONWORKSPACE.COM | Fax (800) 367-6681

ASSEMBLY INSTRUCTIONS
FOR LYON SKY-WAL
TOOL BAR ASSEMBLY

LYON  LYON WORKSPACE PRODUCTS
P.O. BOX 671
201 5201 AURORA, IL 60507

10119AA

SHEET 1 OF 2

TOOL BAR ASSEMBLY

48" / 60" / 72"

1. Attach Tool Bar (A) to 'Z' Bar Support Arms (A007177) by first inserting Rail Nuts (A007182) into 'Z' Bar Support Arms (A007177). Note: Be sure Pen Nut is facing inside of 'Z' bars. Next, secure Tool Bar (A007178) to 'Z' bars (A007177) using (020007) Bolts.
2. Insert Balancer Trolley car (A007288) into open end of attached Spread Bar (A007178) so that Balancer Trolley Car slides freely through Spread Bar (A007178).
3. Insert Plastic Insert Cap (150007) into each open end of Tool Bar (A007178).

BB79309	48"
BB79310	60"
BB79311	72"

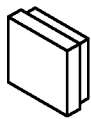

020007

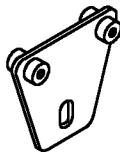

020007



020007



A007182

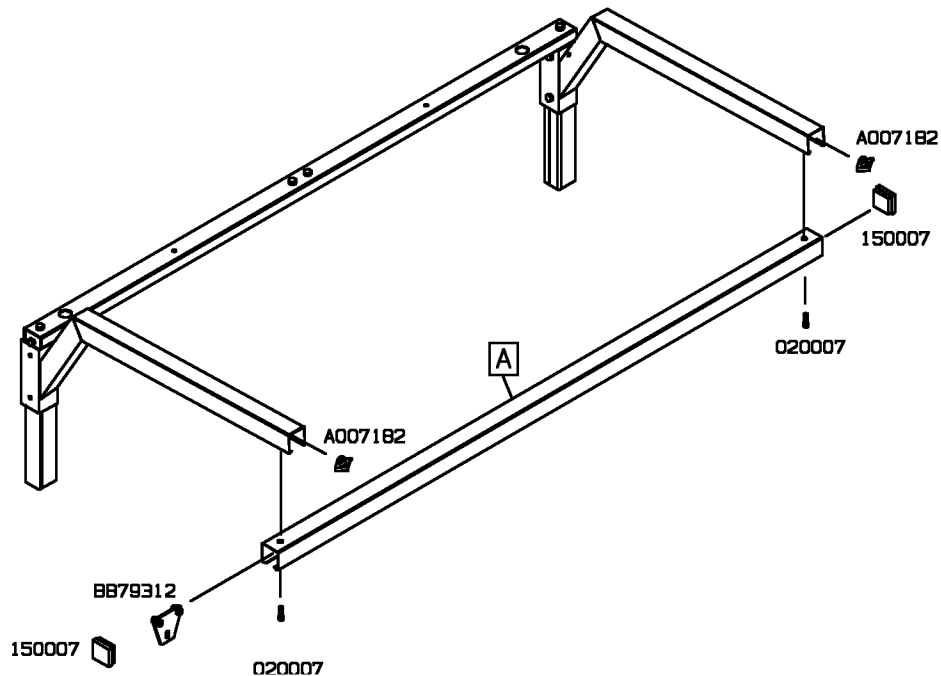

**MISSING PARTS OR IN NEED
OF
ASSEMBLY ASSISTANCE?**

Contact us direct for fast friendly service (800) 433-8488

Int'l calls (630) 892-8941 | WEB: WWW.LYONWORKSPACE.COM | Fax (800) 367-6681

ASSEMBLY INSTRUCTIONS
FOR LYON SKY-WAL
TOOL BAR ASSEMBLY

LYON LYON WORKSPACE PRODUCTS
P.O. BOX 671
201 821 AURORA, IL 60507

10119AA

SHEET 2 OF 2