

PARTIAL PLAN VIEW OF LEFT FRONT

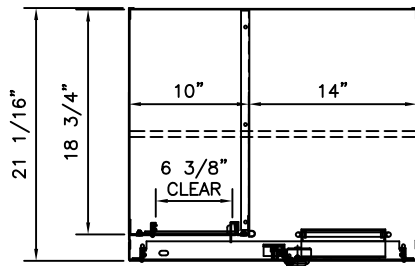

SECTION VIEW

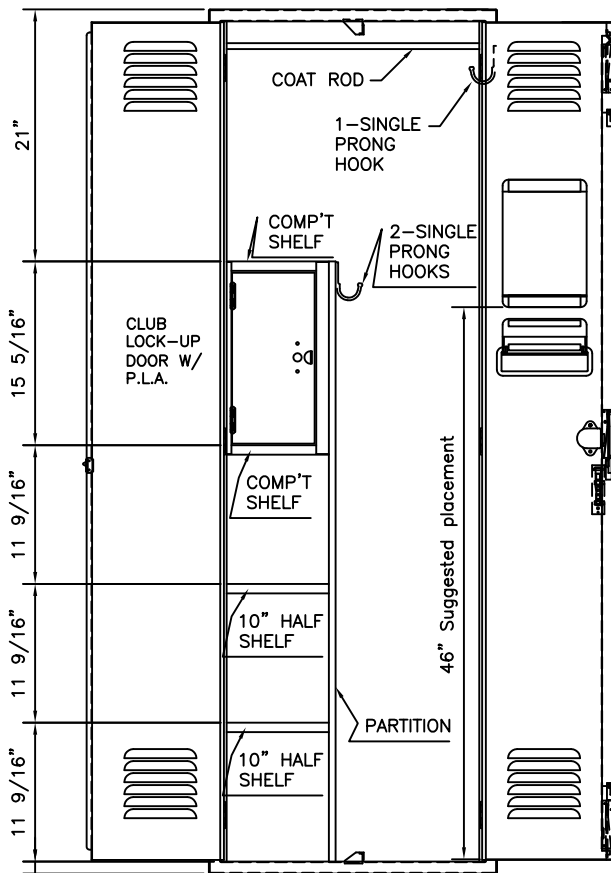

FRONT ELEVATION w/ DOORS OPEN

NOTE: These instructions apply to the installation of the interior components for a Deluxe Club Locker. See assembly instruction 6225-CA for assembly of the main locker body.

1. Bolt a partition to the locker bottom and back using #10 x 3/8" bolts as shown.

2. Bolt four shelves to the partition and to the locker side using #10 x 3/8" bolts. If an inner compartment is supplied, then place the compartment shelves at top two locations as shown.

HARDWARE:

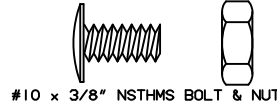

#10 x 3/8" NSTHMS BOLT & NUT

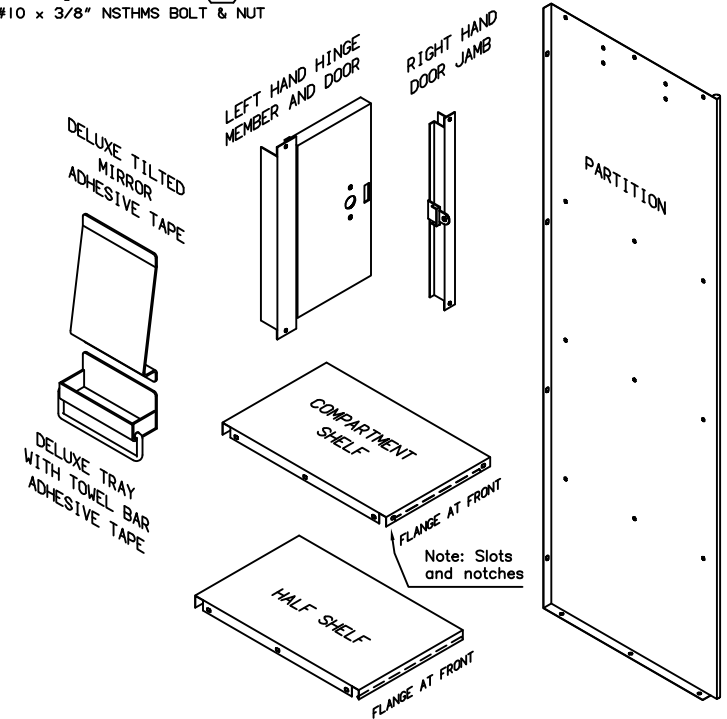

3. If installing an inner compartment, bolt a left hand hinge member and door to the left hand side of the front flange of the first and second shelves using #10 x 3/8" bolts. Then bolt the right hand door jamb to right side.

4. Install a coat rod between the two locker sides as explained in 6225-CA. Attach one coat hook to the right hand locker side, at the top, and two coat hooks at the top of the partition as shown using #10 x 3/8" bolts.

5. Install the mirror and tray by first determining suitable location BEFORE removing covers for adhesive tape strips.

NOTE: The adhesive tape is permanent, and CANNOT be adjusted (or easily removed) after applying - use care.

Verify that the mirror and tray will not interfere with any components when closing the door, and that they are located in an appropriate location for useability. Make sure a hand towel would not interfere with handle mechanism or other components when placing the tray with towel bar.

After determining a suitable location, remove the covers for the adhesive backing strips, and carefully place the components. Insure the alignment is level and square. Do not distort the mirror when attaching.

REVISED	DATE	FACTORY NOTE
E-080904-1	9-15-08	ALL DIMENSIONS SHOWN ARE TO BE HELD TO $\pm 1/32$ " SHEARED EDGES TO BE ON FORMATIONS $\pm 1/64$ " ON HOLE CTRS. UNLESS OTHERWISE SPECIFIED.
		ALL SHARP BURR OR REMOVED WHERE NOTED.

ASSEMBLY INSTRUCTIONS
DELUXE CLUB LOCKERS
 LYON WORKSPACE PRODUCTS L.L.C.

THIS DWG IN BOOK	LYON METAL PRODUCTS		
	DATE	DRAWN BY	CHECKED BY
	9-15-08	ES	
	10848-CA		SHT. 1