

80 CFM FAN ASSEMBLY, GUARD,  
45PPI FOAM FILTER MEDIA,  
AND A MEDIA RETAINER

6. OUTLET SURGE SUPPRESSOR  
MOUNTED INSIDE OF CABINET  
WITH ACCESS HOLE IN BACK  
OF CABINET FOR CORDS/CABLES

REAR ACCESS PANEL

28.25 CABINET DEPTH

30.00 CABINET WIDTH

LOCKABLE UPPER DOOR  
MOUNTED ON PLANO  
HINGE WITH A  
WINDUP OPENING OF  
19.75W x 16.81H  
0.12 THICK  
POLYCARBONATE  
(LEXAN)  
W/GLASS LIKE  
TRANSPARENCY

LOCKABLE  
KEYBOARD  
BODY  
MOUNTED ON  
ACCURIDE  
SLIDES  
DEPTH - 19.36

2494 STATIC  
SHELF DEPTH

5.04 RUBBER  
GROMMET

STATIC SHELF  
TO ACCOMMODATE  
MONITOR/CPU

PRINTER BODY  
MOUNTED ON  
ADJUSTABLE SLIDES  
0.787 CENTERS  
DEPTH - 17.45

2540 PRINTER and  
KEYBOARD BODY WIDTH

LOCKABLE  
LOWER  
DOOR  
MOUNTED  
ON PLANO  
HINGE

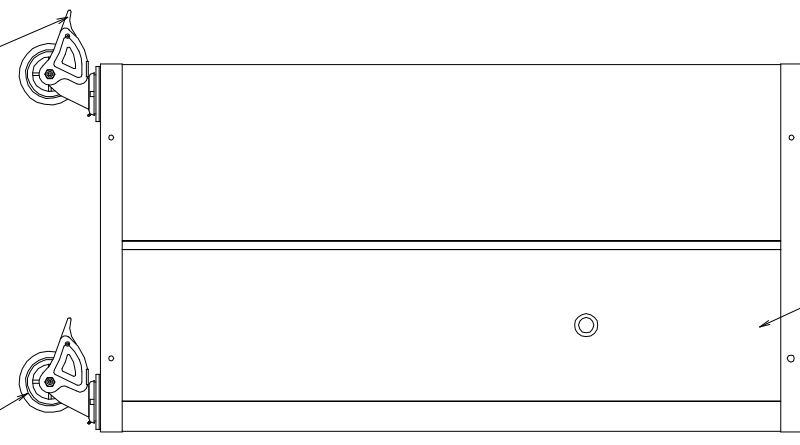

BACK OF CABINET

CASTER FOOT BRAKE

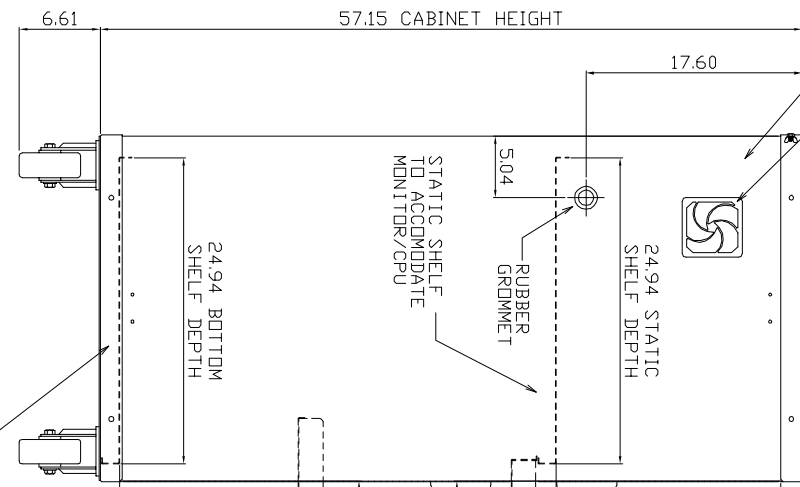

LEFT SIDE OF CABINET

OPTIONAL 5.00 DIA by 2.00 WIDE  
PERFORMA RUBBER SWIVEL CASTERS  
WITH TOTAL LOCK BRAKE FOR  
MOBILE APPLICATION

BOTTOM SHELF  
TO ACCOMMODATE CPU  
OR ACCESSORIES

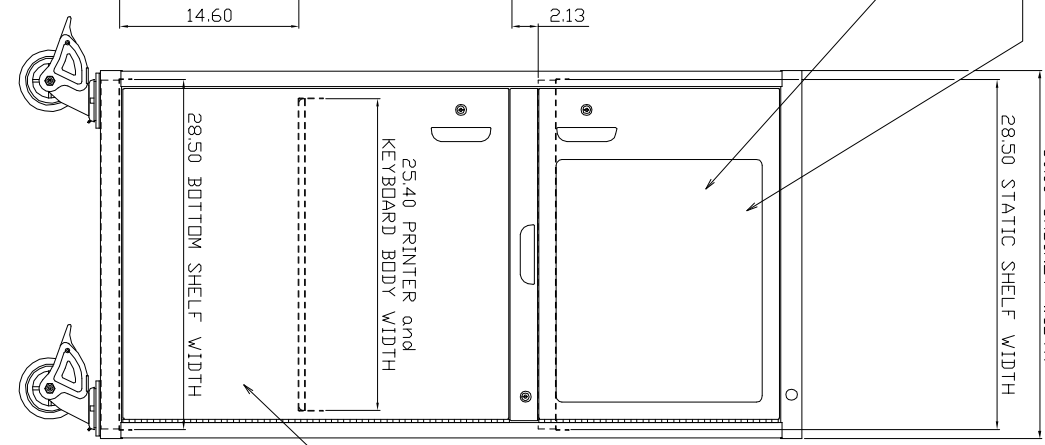

FRONT OF CABINET

SEE OPPOSITE SIDE FOR FURTHER DETAILS



P.O. Box 671  
AURORA, IL 60507-0671  
PHONE: 630-892-8941  
FAX: 800-567-4681

NOTICE: THIS IS A CONFIDENTIAL DISCLOSURE LOANED BY  
LYON WORKSPACE FOR REFERENCE PURPOSES ONLY

DATE	DRAWN BY	CHECKED BY
02-01-12	JR	DWV

DESCRIPTION

PC CABINET OPTIONS/SPECS  
MDC

SHEET	DRAWING NUMBER	REV
1	SS1379-AA	1

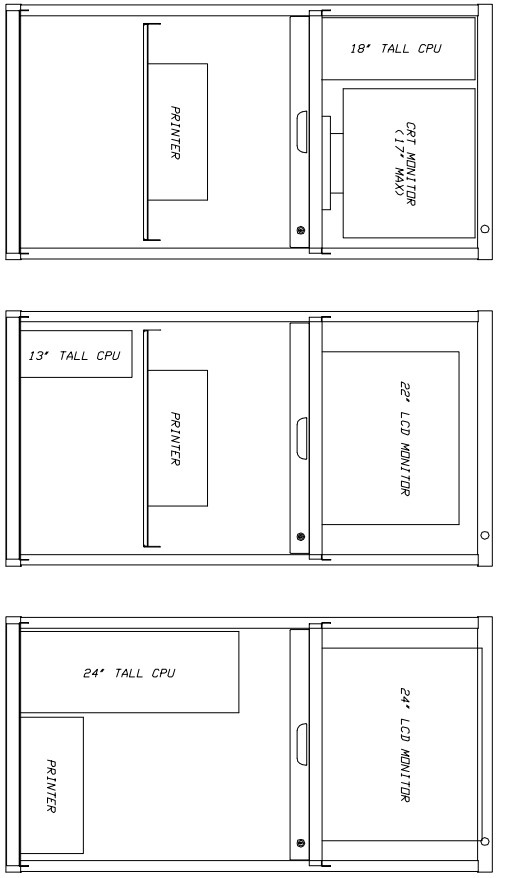

The PC Cabinet can accommodate a wide variety of CPU's, Monitors and Printers. Shown above is just a few of the installation configurations that can be done. The Printer tray is height adjustable in 3/4" increments, allowing a multitude of positions. A Mid-tower case or a Mini-tower case can be placed on the top shelf along with a CRT monitor no larger than 17". Some 24" LCD monitor's can be placed on the top shelf without a CPU. A full-tower case can be placed on the bottom shelf with the printer tray removed. No matter what hardware you have, the cabinet can be configured to fit most anything.

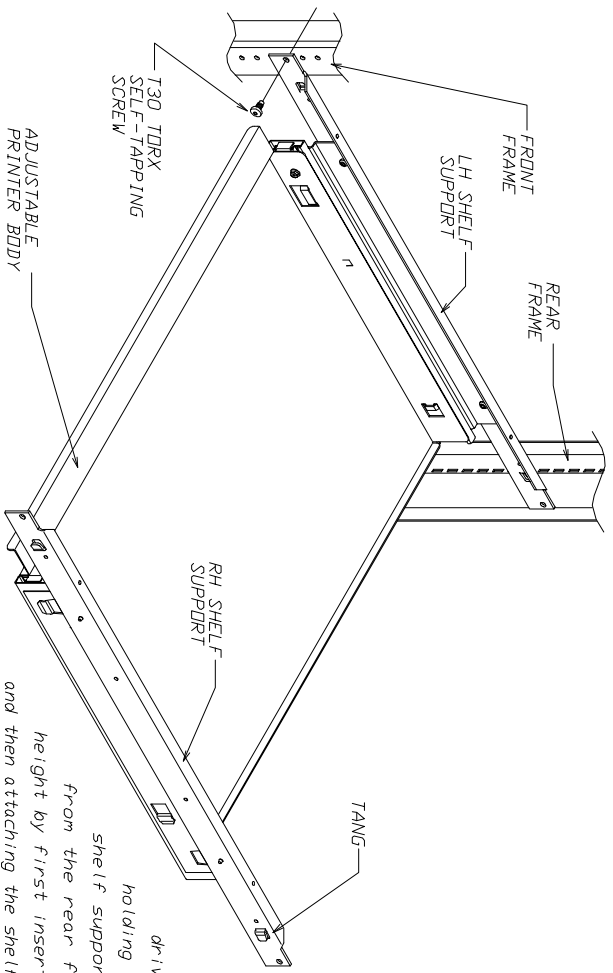

holding the shelf supports to the front frame. Grasp the shelf supports and pull out slightly to remove the tangs from the rear frame. Reposition the shelf to the desired height by first inserting the tangs into the slots on the rear frame, and then attaching the shelf supports to the front with the self-tapping screws. Make sure the supports are level and in-line with each other.

**INTERIOR VIEW OF PC CABINET CABINET TOP, SWING DOORS, NOT SHOWN FOR CLARITY**

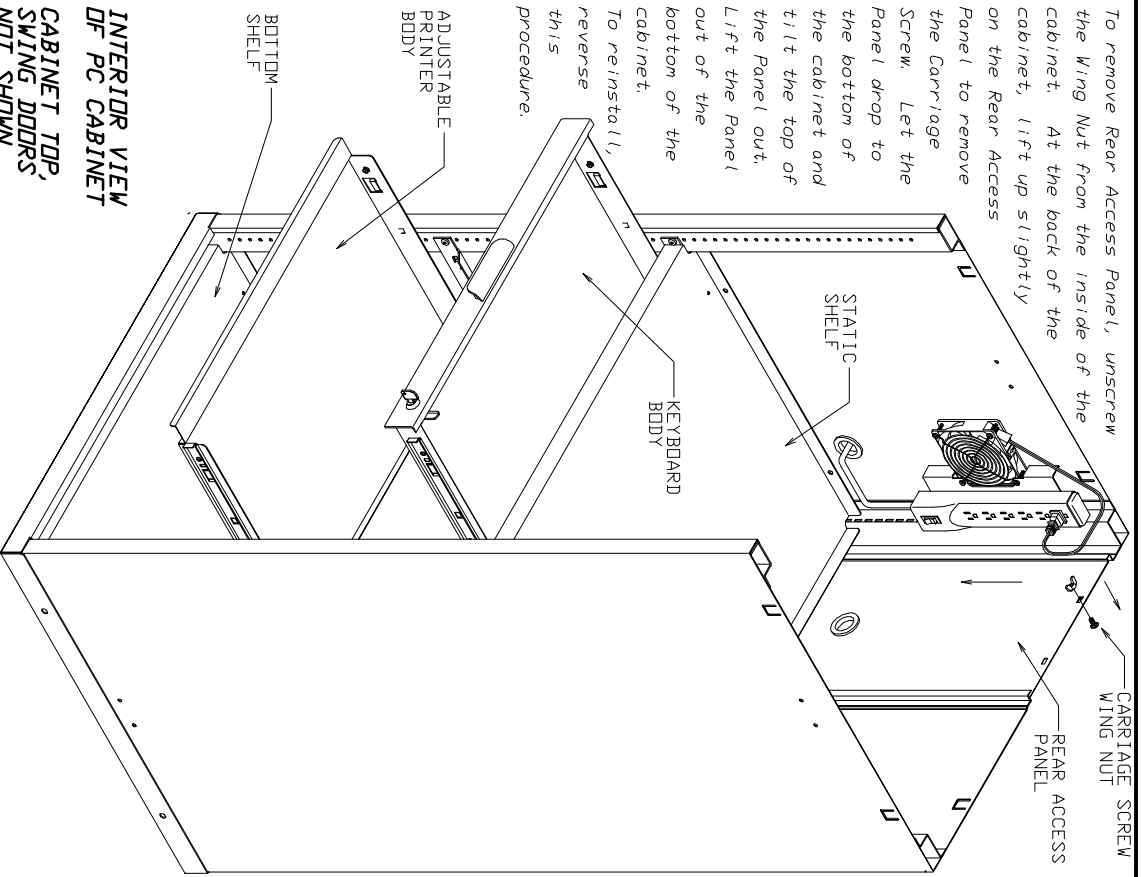

To remove Rear Access Panel, unscrew the Wing Nut from the inside of the cabinet. At the back of the cabinet, lift up slightly on the Rear Access Panel to remove the Carriage Screw. Let the Panel drop to the bottom of the cabinet and tilt the top of the Panel out. Lift the Panel out of the bottom of the cabinet. To reinstall, reverse this procedure.

**ADJUSTMENT PROCEDURE FOR TRAY**

1) Printer body is assembled complete at the factory. To reposition the tray, using a T30 TORX driver, remove the two (2) self-tapping screws that are holding the shelf supports to the front frame. Grasp the shelf supports and pull out slightly to remove the tangs from the rear frame. Reposition the shelf to the desired height by first inserting the tangs into the slots on the rear frame, and then attaching the shelf supports to the front with the self-tapping screws. Make sure the supports are level and in-line with each other.

**LYON**  
P.O. Box 671  
AURORA, IL 60507-0671  
PHONE: 630-893-2841  
FAX: 800-567-4681

NOTICE: THIS IS A CONFIDENTIAL DISCOBURE LOANED BY LYON WORKSPACE FOR REFERENCE PURPOSES ONLY  
DATE: 02-01-12  
DRAWN BY: JR  
CHECKED BY: DMW

DESCRIPTION  
**INSTALLATION PC CABINET OPTIONS/SPECS MDC**

SHEET	DRAWING NUMBER	REV
2	SS1379-AA	1